

# 65" PELHAM ACRYLIC FREESTANDING TUB

Cat. No.  
ATOVN65LIG-XX



L: 64-3/4"  
W: 31"  
H: 23"

Water depth: 17-3/4" to top of tub  
Water depth: 13-1/4" to overflow  
Overflow hole diameter: 3-3/4"  
Center drain to back of rim: 15-1/2"  
Sitting area: 16-1/2"

## Features:

- ▶ Interior and exterior walls acrylic sheets
- ▶ Overflow slot with integrated drain
- ▶ Drain included
- ▶ Drain and overflow cover included
- ▶ Angle slope of tub: 65°
- ▶ Rim is 3" wide
- ▶ No faucet holes
- ▶ Includes built-in adjusters
- ▶ Tub is thoroughly inspected before shipment
- ▶ Option to add foam insulation between tub walls available



## Finishes:

<b>BN</b>	Brushed Nickel
<b>CP</b>	Polished Chrome
<b>ORB</b>	Oil Rubbed Bronze
<b>PB</b>	Polished Brass
<b>PN</b>	Polished Nickel
<b>WT</b>	White

**Custom Colors Available** (inside of tub is always white enamel):  
Painted bathtubs are considered "special order" and are not returnable  
\$160 Bisque or Black \$250 Designer Color

The following is recommended for  
ATOVN65L tubs:  
•Freestanding filler: part #7932,7952 or 7918  
(Does not need bath supplies)



**For easier installation we  
recommend use of 5598-ITD  
Easy Install Rough In Kit**

Gallon Capacity: 46  
Shipping Weight: 230 lbs.  
Empty Weight: 120 lbs.  
Filled Weight: 504 lbs.

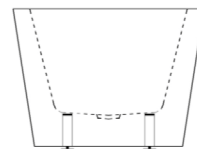
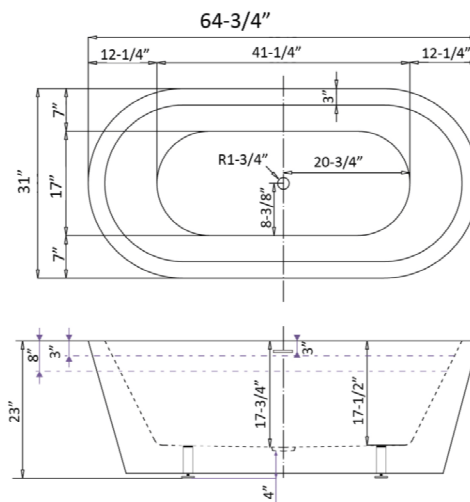

Dimensions of fixture are nominal and specifications subject to change without notice.

02/12/2021

P 847•244•1234

www.barclayproducts.com