

California Faucets®

D Street™

TWO HANDLE TUB OR SHOWER TRIM

Features

- Available in 28 finishes including 13 PVD finishes
- All brass construction
- Less head, arm, flange, and spout
- Requires rough valve: 2-VR or VL-R (sold separately)

**TO-5306L
TO-5306FL
TO-5306KL**

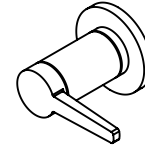
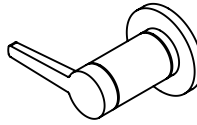

Codes/Standards Applicable

- Product meets or exceeds the following:
- ASME A112.18.1/CSA B125.1
 - ADA compliant

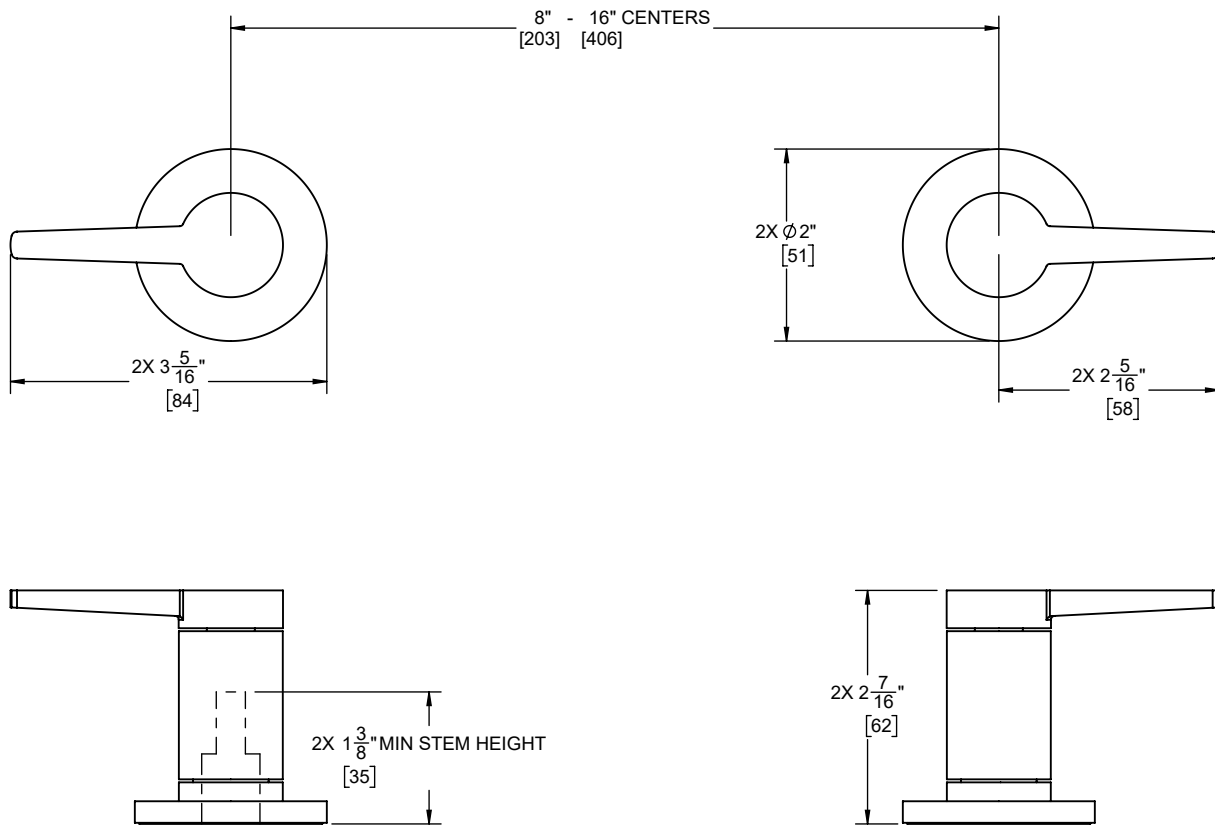

THROUGH-HOLE SPECIFICATIONS

MIN	RECOMMENDED	MAX
ϕ 11/16" [17]	ϕ 1-1/4" [32]	ϕ 1-5/8" [41]

DIMENSIONS SHOWN TO NEAREST 1/16"
[DIMENSIONS SHOWN TO NEAREST 1MM]

SPECIFICATIONS SUBJECT TO CHANGE WITHOUT NOTICE