

Clarion

BATHWARE

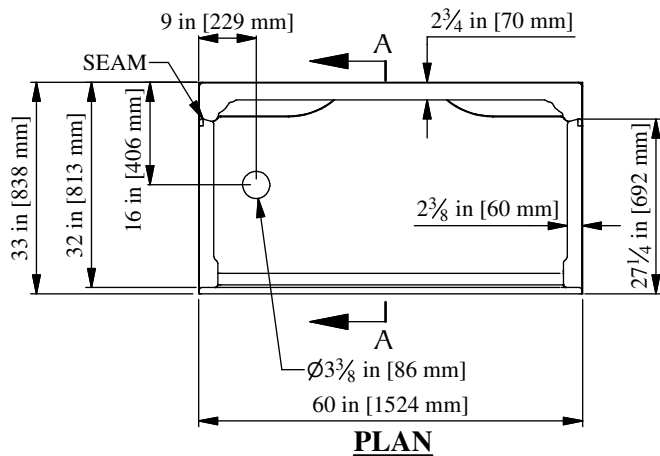
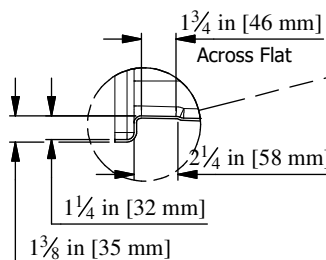
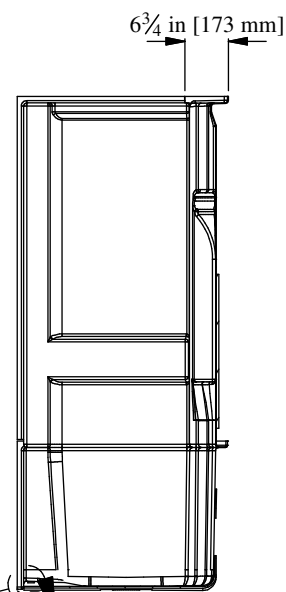
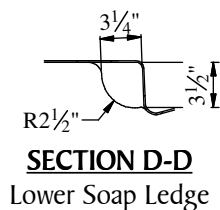
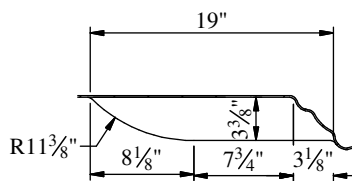
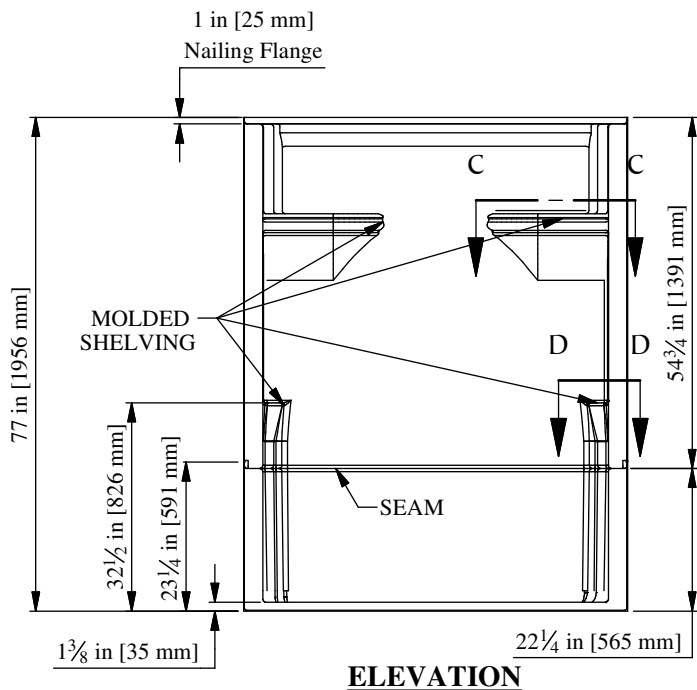

60" [1524mm] 4-Piece Shower
w/ 1 1/4" Threshold & Molded Shelving

Left Hand Version (4MSI1LBF54) Shown

PRODUCT SPECIFICATIONS:

- * Certified to meet CSA B45.5/IAPMO Z124 Standard.
- * Product has a Class B fire rating as determined by ASTM E-84 test method.
- * Special installation instructions for this unit must be followed carefully.
- * Can accept a shower door, but custom fitting and special attention to ensure the threshold is flat will be required.
- * Door Opening: W-54" [1372mm]
H-74" [1880mm]
- * Reinforced & slip resistant floor.
- * Molded shelving on back wall.
- * Integral 1" [25mm] nailing flange.
- * Integral 1" [25mm] floor nailing flange.
- * All dimensions +/- 1/2" [12.8mm]
- * Clarion Bathware reserves the right to change design and/or dimensions.
- * Dimensions are the same for all other versions of this model.
Which include 4S11LBF54 or 4S11RBF54

4MSI1LBF54 or 4MSI1RBF54

60" [1524mm] 4-Piece Barrier-Free Shower w/ 1 1/4" Threshold, Left or Right Hand Drain, & Molded Shelving

Clarion
BATHWARE
44 Amsler Ave.
Shippensburg, PA 16254

Phone: (814) 226-5374
Toll Free: (800) 576-9228
Fax: (814) 226-0730
www.clarionbathware.com

Signatures For Approval:

Customer: _____
Arch./Engr: _____

Date: _____

Quote #: _____
Job Name: _____

4MSI1LBF54 or
RBF54-Cut

Dwg. By: CAL
Date: 5/28/2021